

DIGITAL LEVEL

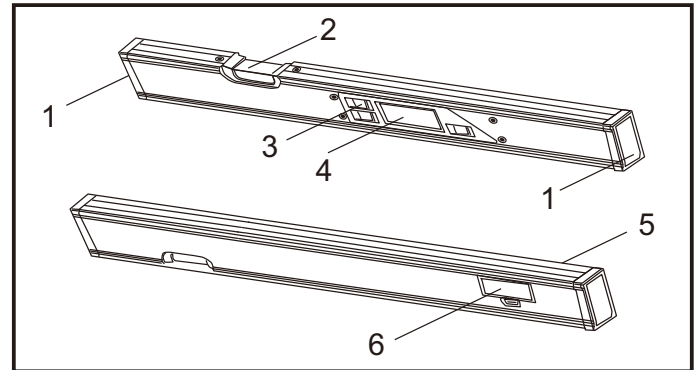

KNOW YOUR LEVEL

- 1) Endcaps-Ends cushioned to help protect level from damage.
- 2) Bubble Vial-The level or plumb of a surface can also be accurately measured by positioning the bubble inside the vial in between the marks on the vial's surface.
- 3) Keyboard
- 4) LCD Display-With blue backlight. Large, easy-to-read display screen reads right side up even when level is upside down.
- 5) Measuring surface-only bottom surface is the measuring surface
- 6) Battery compartment-Holds two AAA batteries to power the LCD display (included)



IMPORTANT NOTE :

- 1) The digital level has been pre-calibrated at the factory.
- 2) The level should only be recalibrated if level has been dropped. (see Calibrating your Level)

LCD SCREEN ICONS

- Replace batteries when the Battery Power Icon is displayed. Only displayed when battery power is low.
- Sound/Beeper Icon-This icon appears on the screen when the beeper function is activated.
- REF** Indicates that the level is working in relative angle mode.
- H** This icon appears on the screen when the HOLD function is activated.
- 1- Indicates that the digital level is calibrating for one direction.
- 2- Indicates that the digital level is calibrating for another direction.

KEY FUNCTIONS

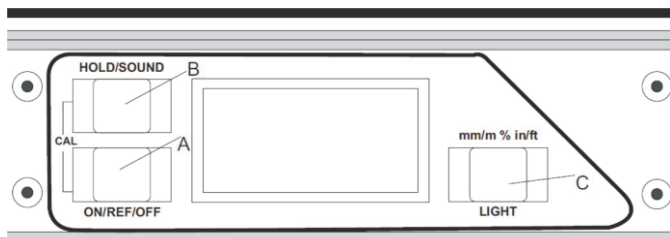

Fig. 1

- 1) Button A - Press once to turn the LCD display screen on. Press the button again to set current angle to zero, REF icon will be displayed to indicate relative angle measurement mode. HOLD button A for 3 seconds to turn off. An auto-off feature shuts the display off after a period of inactivity to preserve battery life.
- 2) Button B — press once to enter the HOLD function and for the H icon be displayed, press once again to release hold function. Press and Hold button for 3 seconds to activate sound function. Beeper will sound at level(0) and plumb(90). The sound function utilizes a series of beeps that increase in tempo eventually reaching a constant tone at exactly 0 and 90 degrees as it approaches 0 and 90 degrees and
- 3) Button C- converts angles to different units. Push once to change the display units from degrees (°) to mm/m, to percent slope (%), to pitch (in/ft). Hold button for 3 seconds to turn on light. Touch any key to then illuminate the display while light function is on. Hold button again for 3 seconds to turn off light.

CALIBRATING YOUR LEVEL(Figs.2,3)

- 1) Place the digital level on a flat and smooth surface, press A button and B button at the same time, the calibration mode is activated and "-1-" will be displayed. Press A button again, -1- will flash briefly. Do not move until -2- is displayed.

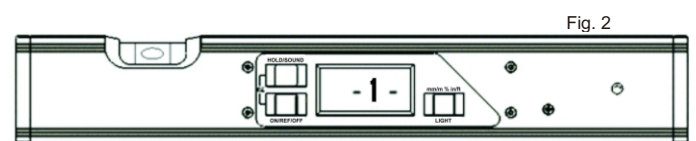

Fig. 2

- 2) Rotate the level 180 in the same location and press A button, -2- will flash briefly. Do not move until the unit has completed the calibration and reset the display to the current level.

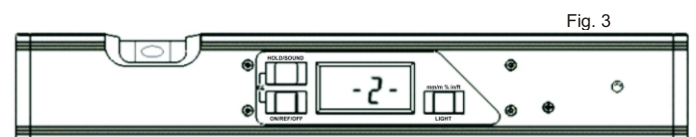

Fig. 3

HORIZONTAL(Fig.4)

Once the Power button is turned on, lay the level on the surface you want to level. In standard ABS mode the LCD display will show the surface you are measuring as a line either above or below the true level line, and the degree to which the surface is off, with symbol +/- showing how to adjust the surface to be leveled

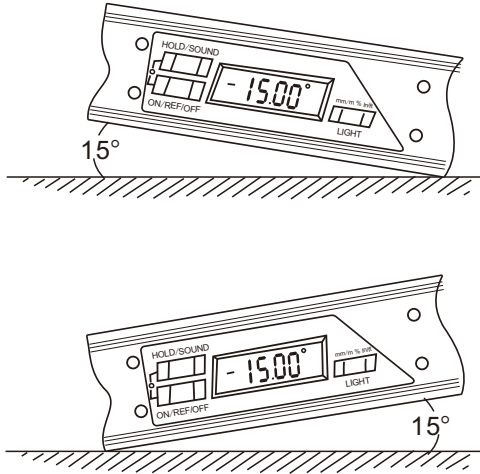

Fig. 4

If the beeper is activated, the beeper will sound at 0 and 90 .

PITCH(Fig.5)

The digital level can be used to measure the pitch of a roof. It measures the pitch in inches of rise per foot or millimeters of rise per meter of run. Push button C for the appropriate mode.

Fig.5

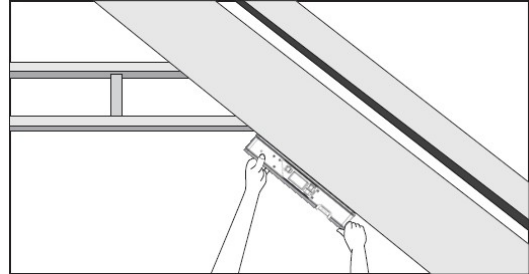
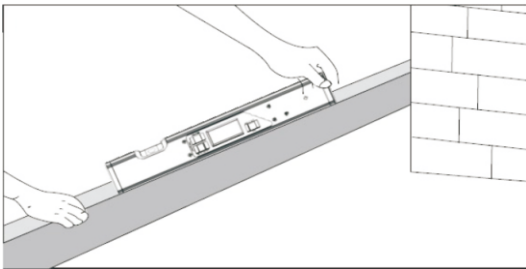

Fig. 6



SLOPE(Fig.6)

The digital level measures the slope of a surface in percent. This is useful when laying pipe for proper drainage. When the conversion button is in the slope mode, it will display (%). If the sound mode has been activated, the level will beep at 0.0%.

SPECIFICATION

Power supply	2 x 1.5V AAA batteries
Angle measuring range	4 x 90
Resolution	0.05
Accuracy of digital display	0&90 : 0.1 , others 0.2
Accuracy of vial	+/- 0.029°
Working temperature	-10 C to 50 C
Storage& shipping temperature	-20 C to 70 C
Auto shut off	After 5 minutes of inactivity.



GemRed

GUILIN GEMRED SENSOR TECHNOLOGY CO.,LTD

Address: 618-Bldg.B,West Kong Ming Road Guilin Pioneering Park Of Overseas Scholars Guilin Guangxi China

Tel: 86-773-5830033 5822678 5830055 Fax: 86-773-5800296

Http://www.gemred.com E-mail:sales@gemred.com